

## Welcome to Wallpassion

### Useful tips before you start wallpapering

In this brochure, you can find a wallpaper guide – feel free to spend a few minutes reading through it. It will save you both time and energy and, most importantly, will make putting up your chosen wallpaper easier.

If you chose our well-thought-out tool kit and/or our offer of glue adapted to your needs, you can simply get started. If not, the guide will tell you what you need. Did you know that our environmentally-sound wallpaper box can be of use when putting up wallpaper when rolling glue directly onto the wall? See below.



Pull off the marked slit

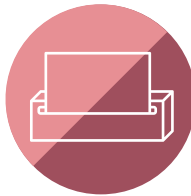

Thread the length of wallpaper through the opening with the patterned side against the wall



This allows for simpler wallpapering and the wallpaper is protected throughout the installation

Enjoy! And don't forget that our visitors love seeing your finished rooms at #yeswallpassion

Best wishes from us at Wallpassion

# Wallpaper guide

general tips & guidance

Read this page first before you start wallpapering in order to save time and achieve a better result.

## YOU WILL NEED

- Glues (adapted to your wallpaper)
- Bucket/trough
- Roller
- Brush
- Plumb line
- Wallpaper tool/wallpaper brush
- Knife/stanley knife
- Ruler
- Clean water
- Rags/towels
- Sponge
- Wallpaper tray (cardboard works well)
- Ladder
- Pasting table (for paper wallpapers)

## PREPARATORY WORK

### Are the walls uneven?

Fill holes and other irregularities using putty. Once the putty has dried, sand the wall and dust off the wall and the room to clean it up.

“The purpose of preparatory work is to have a wall that is smooth, dry and clean.”

### Is the wall painted?

If the wall is painted a dark colour, this may show through the new wallpaper. In this case, we recommend priming the wall beforehand. Alternatively, the wall can be washed with paint cleaner and allowed to dry.

If the paint is flaking, the wall needs to be sanded first. If the wall is very glossy, use sandpaper to make adhesive for the wallpaper. Don't forget to dust off the wall afterwards.

### Is the wall already wallpapered?

Remove all wallpaper that is loose, sand, and fill seams if applicable. A tip is to lightly tap your fingers on different areas of the wall. If the sound is completely mute, there may be air underneath, which means that the wallpaper is loose and needs to be removed. If you wallpaper over an old wallpaper that is loose, air bubbles will occur easily.

Textured and straw wallpapers and the like should be removed completely.

## QUESTIONS AND ANSWERS

### Where do I start?

If the wall/room has a window or door, start there and wallpaper from the edge of the window or door.

### How do I wallpaper a corner?

To achieve a stable corner that doesn't crack, the wallpaper needs to overlap the corner by about 1 cm. As you approach a corner, measure the distance from the edge of the strip of wallpaper to the corner. Measure at both the top and bottom. If the measurements are different, use the largest measurement. Add a centimetre so that the wallpaper can reach around the corner. Cut the strip of wallpaper that will overlap the corner with a wallpaper knife and ruler and save the piece that is left over for the next step. Apply glue to the wall and attach the strip of wallpaper that will go over the corner. Attach the wallpaper so

that it overlaps the strip of wallpaper in the corner as close to the corner as possible. Check that the strip of wallpaper is straight and that the pattern matches up correctly. Smooth out using the wallpaper tool. Press so that it attaches to the corner securely.

#### Nonwoven wallpaper that looks spotty?

Nonwoven is a permeable material and moisture stains on the wallpaper disappear when the glue dries.

NOTE! Keep in mind that glue stains on the front of the wallpaper must be removed immediately with a damp sponge.

#### Wallpapering over electrical outlets:

Be sure to turn off the electricity in the room first. Then remove the outlet covers over the electrical outlets.

#### Ventilate the room properly!

A newly wallpapered room should not be completely enclosed, but also not be exposed to drafts or extreme temperatures.

#### Drying time

Make sure that the wallpaper has time to dry for at least 1 day before you place furniture against it and 2-3 days before putting up paintings or shelves.

#### Tip!

Double check that the wallpaper rolls have the same batch number. When buying a photo wallpaper, doublecheck the motif, the order in which the strips of wallpaper need to be installed, and that there are no printing errors.

If any glue gets on the front of the wallpaper or between the seams,

wipe it off immediately with a damp sponge.

The wallpaper knife needs to be sharp. Make sure to change the blade as soon as you notice it starting to become dull. Wallpapering is sticky (if not, you're not using enough glue). Have clean water and a clean towel ready so you can dry yourself off before picking up strips of wallpaper.

# Installing nonwoven

**Nonwoven wallpapers** are made of a non-organic material, which makes them dimensionally stable and less sensitive than the old, classic paper wallpapers. Nonwoven wallpaper is also called "easy-up" or "quick-up," and the main advantage is that you apply glue directly to the wall, and the wallpaper itself is ready to put up as soon as you unpack it. Today, most wallpapers are made of nonwoven materials.



**1.** Roll the wallpaper glue onto the wall across two widths of wallpaper at a time. Don't skimp on the glue, and make sure that the entire surface is evenly wet to prevent bubbles. Use a brush to fill in glue at the seams and skirting boards.



**2.** Use a plumb line to check that the first strip of wallpaper is straight.



**3.** The box the rolls came in acts as a tray and protects the strips of wallpaper. Place the box on the floor with the wallpaper roll inside, pull the wallpaper up against the wall, and start applying the wallpaper at the ceiling without cutting off at the bottom. Attach the strip of wallpaper with a few centimetres of overlap over the base of the ceiling moulding and then trim along the edge. If your wallpaper is made to measure, put it up without an overlap.



**4.** Use a brush (for photo wallpapers) or wallpaper tools (for standard wallpapers) to smooth the surface of the wall. Push downwards and outward. If any glue gets on the tool, wipe it off immediately with a clean, damp cloth. **Make sure to avoid air bubbles!**



**5.** If the wallpaper is not made to measure, trim off the edge at the bottom. You can use the wallpaper scraper to make sure that the edge is straight and that you don't cut off too much.



**6.** Make sure that the glue you applied for the next strip has not dried out. Roll on more glue if needed. Pay special attention to making sure the glue has not been removed from the edge of the previous strip. Supplement with a brush if needed.



**7.** The next strip is to be placed edge to edge with the first. If the strip that you have just put up has become skewed or bubbly, lift or remove the entire strip and re-attach it from step 1. If you try to twist the wallpaper strip, there is a risk that it will be crooked or bubbly, meaning that the next edge will also be skewed.



**8.** Good job! Continue in the same way until all the strips of wallpaper are in place!

# Tips on how to use leftover pieces of wallpapers

## Frame a leftover piece of wallpaper

Wallpapers really are pieces of art and make for the perfect motif on a picture wall. Do you have any leftover frames lying around at home? Cut the piece of wallpaper to the frame's size and hang it up. Inspiringly simple!

## Notebooks - use the wallpaper as a beautiful cover

Four simple steps to make a beautiful notebook for yourself or someone you care about. You will need a little leftover wallpaper, thick A4 paper, glue, A4 size printer paper and a stapler.

**Step 1** - Cut out the piece of wallpaper to A4 size (use a piece of A4 paper as a template)

**Step 2** - Apply glue to one side of the thick A4 paper. Attach the back of the wallpaper to the glued A4 paper. You now have a nice cover.

**Step 3** - Fold as many pieces of printer paper as you want to have in the notebook (10 pieces of paper is a good suggestion) to A5 size, and fold the thick A4 paper with the piece of wallpaper glued onto it (the cover) to A5 size.

**Step 4** - Insert the folded pieces of printer paper inside the cover. Fold out the cover & printer paper to A4 size and staple 2 staples in the centre. All done!

## Envelope

Fold an envelope out of a leftover piece of wallpaper. Who doesn't love getting a handwritten letter through their letterbox?

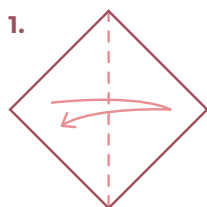

Fold the paper over in the centre

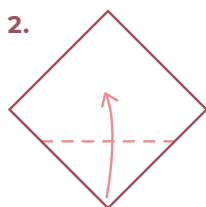

Fold the bottom part of the paper upwards

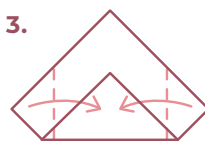

Fold the bottom part back. Fold the left and right parts of the paper inwards.



Glue the underside and then fold up the bottom part.

## Gift wrap

Use the leftover pieces of wallpaper to wrap up a parcel. Feel free to use a matching ribbon. Beautiful and inspiringly simple!